

The information contained in this drawing is the sole property of CMS Coil Winding Specialist. Any reproduction in part or whole without written permission of CMS Coil Winding Specialist is prohibited.

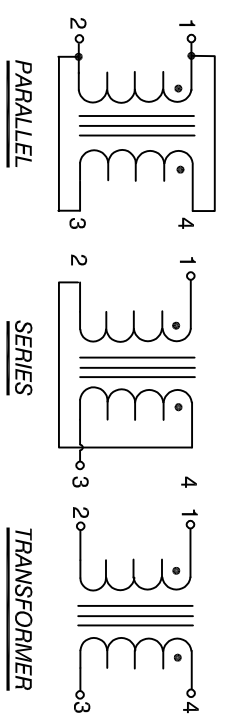

- 7 BUILT TO ROHS COMPLIANCE AND LEAD FREE AND REVISION WHERE SHOWN IF APPLICABLE MARK PART NUMBER
- 6 REMOVE INSULATION AND TIN LEADS
- 5 WIND ON TO CORE AND EVENLY SPACED
- 4 CONSTRUCTION:

TO INSURE INTERGRITY OF WINDING SEPARATION HI-POT TEST FOR WINDING TO WINDING = 300 VDC MIN.  
 SERIES DCR = 1.488 OHMS MAX.  
 SERIES FULL LOAD CURRENT = 0.41 AMPS. DC.  
 SERIES FULL LOAD INDUCTANCE = 308.69 uH MIN.  
 SERIES OPEN CIRCUIT INDUCTANCE = 592.90 uH @ ± 20 %

PARALLEL DCR = 0.372 OHMS MAX.  
 PARALLEL FULL LOAD CURRENT = 0.82 AMPS. DC.  
 PARALLEL FULL LOAD INDUCTANCE = 77.17 uH MIN.  
 PARALLEL OPEN CIRCUIT INDUCTANCE = 148.23 uH @ ± 20 %

- 3 SPECIFICATIONS:
- WIRE: UL RECOGNIZED 130°C RATING MAGNET WIRE
- CMS BYTE-MARK OR OTHER APPROVED PART
- CORE: TOROID

- 1 BOBBIN RATING CLASS B (130°C) REQUIRED MATERIAL: UL RECOGNIZED 94V-0 FOR FLAMMABILITY
- NOTES: UNLESS OTHERWISE SPECIFIED, READ FROM BOTTOM UP.

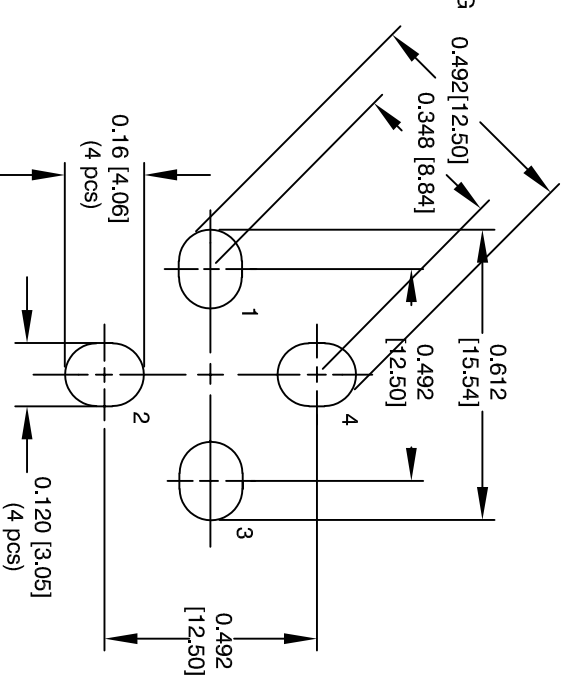
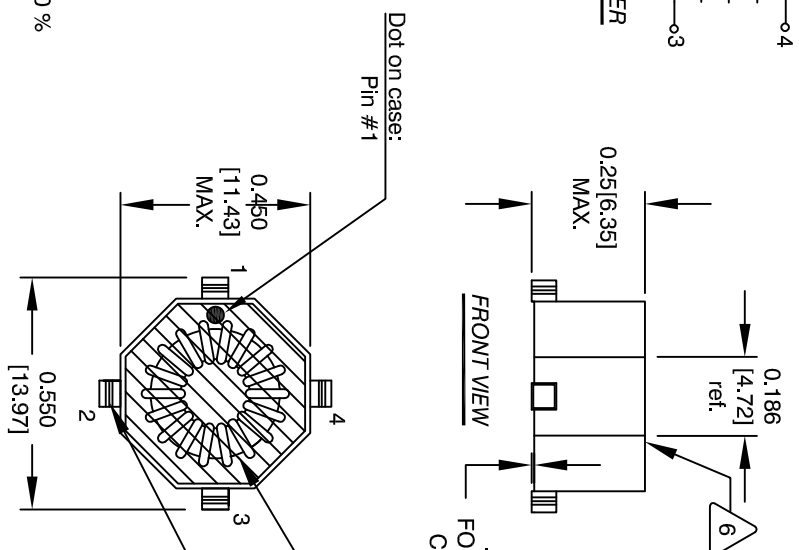

REVISION HISTORY

REV	ECN	DESCRIPTION	BY	DATE	CHK	DATE
A		PRODUCTION RELEASE	RRR	4/26/05	JLJU	4/26/05
B		FOOTPRINT AND NOTE UPDATE	RLL	4/30/11	JLJU	4/30/11
B1		FIXED DIM DESCRIPTION & ADDED DOT FOR PIN #1	TN	09/09/24	JL	09/09/24

UNLESS OTHERWISE SPECIFIED	
DIMENSIONING AND TOLERANCE PER ANSI Y14.5M	
ALL DIMENSIONS ARE IN INCHES AND [MILLIMETERS]	
TOLERANCE INCHES:	± = +0°30'
XXX±.010 -XX±.015	± = +0°30'
TOLERANCE METRIC:	± = +0°30'
XXX±.254 -XX±.318	± = +0°30'
ANGLE PROJECTION	
DO NOT SCALE DRAWING	

QTY	CODE	MFG. P/N	DESCRIPTION	ITEM NO.
	IDENT			
PARTS LIST				
AUTOCAD		X		
SOLIDWORKS		SIGN DATE		
DRAWN	RPR	4/26/05	TITLE: Parallel Series Inductor	
REQD	JLJU	4/26/05	sales@coilws.com	
ENGR.	KSUM	4/26/05	353 W. Grove Avenue	
APPR.	JLJU	04/28/11	Orange, CA 92865	
SCALE		NOT TO SCALE		REV
B		CX150-4-SD		B1
SHEET		1 OF 1		